

Welcome...

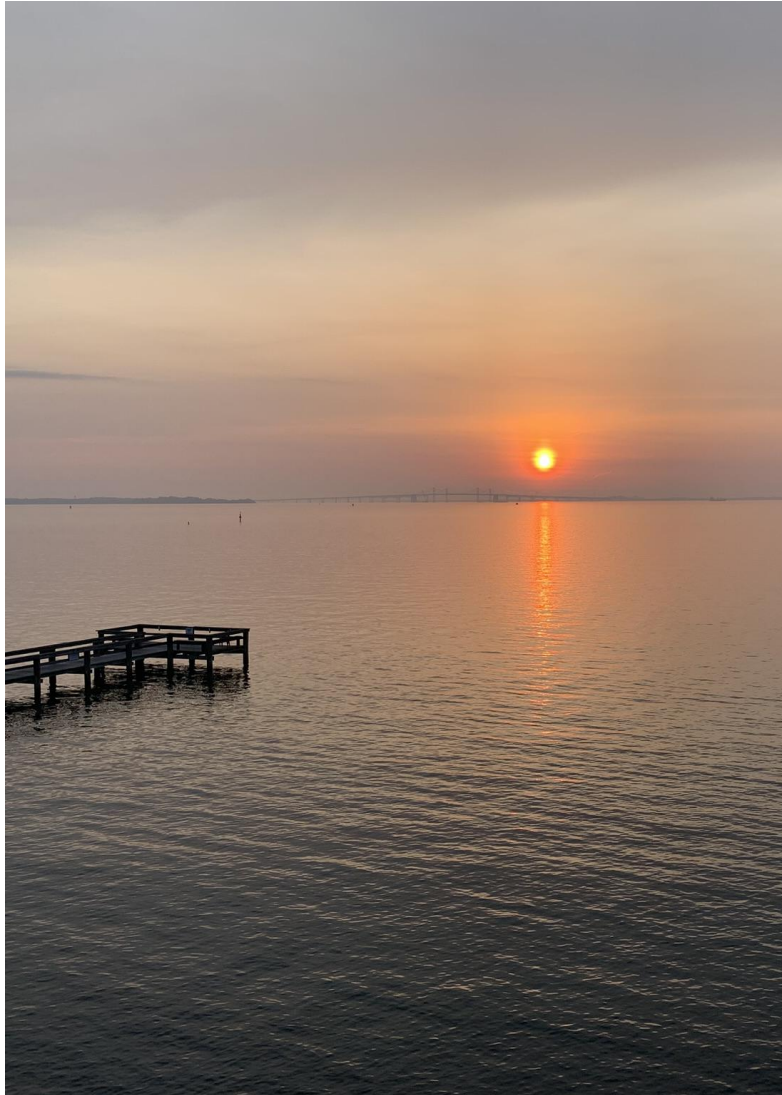

Open House May 16

Introducing 2127 #202 Beach Village Ct.

\$1,197,000
Furnished, Turn Key

Chesapeake Harbor
Waterfront, furnished
Turn Key condo.

(Buyer agent participation
welcomed)

Index...

CONTROL-Click on graphic below, right, on any page to return to this index

- [3. Link to overview and location](#)
- [7. View: Where everything is](#)
- [11. LR/Deck](#)
- [12. Main living room area](#) & dining
- [16. Main Bay deck](#)
- [17. Kitchen/Galley](#)
- [19. Master Bedroom](#)
- [21. Master Bath](#)
- [22. Transition & utilities](#)
- [24. Lower Guest room](#)
- [26 Guest bath and storage](#)
- [27. Upper loft/storage space](#)
- [28. Loft—flexible space](#)
- [35. Contact information](#) Pricing

[Link to features & available furnishings,](#)
included in Turn Key Pkg.

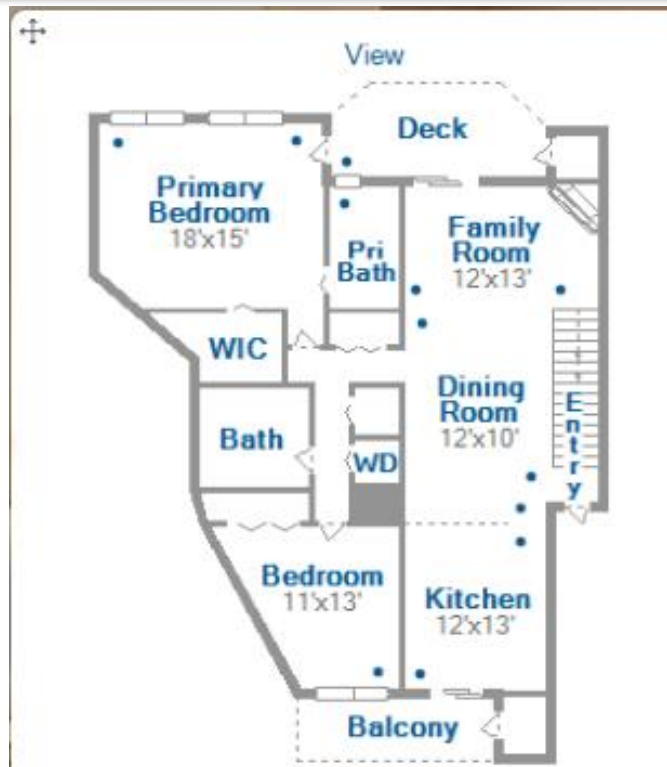

This two story, luxury condo is being offered furnished, Turn key

Use it as your second, vacation home, permanent home, or rental property—available furnished!

Use the menu to jump to subject of interest or scroll through the presentation. Click on graphic below to return to this index

Pictures, mostly by owner, non-professional but informative



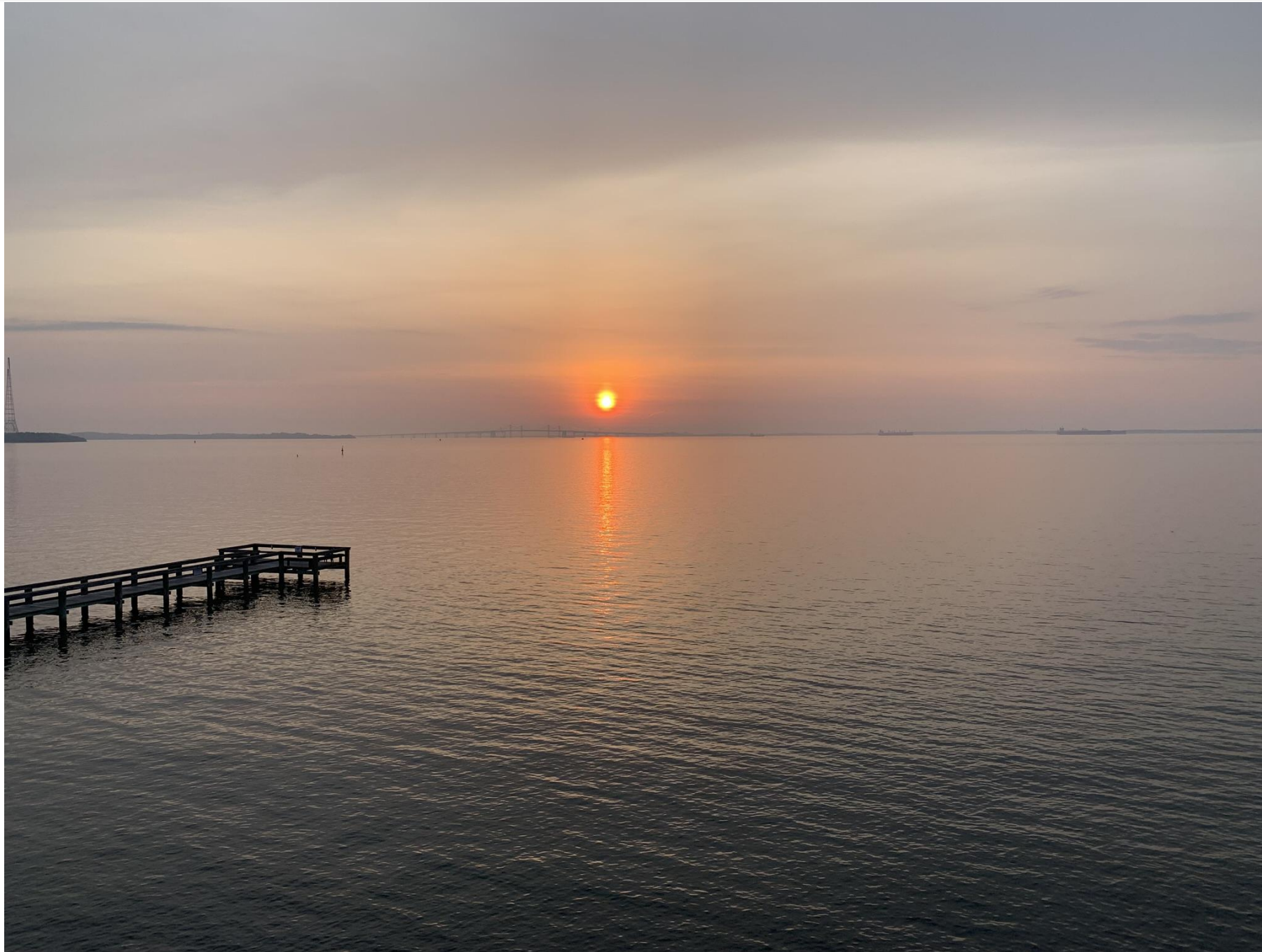

Morning view...

Escape to resort-style living in this beautifully appointed **2-story penthouse condo** located in the **gated waterfront community of Chesapeake Harbour** — just minutes from downtown Annapolis and only 45 minutes to both Baltimore and Washington, D.C. With three major airports nearby, **BWI is just 35 minutes away**, offering convenient access for business or leisure travel.



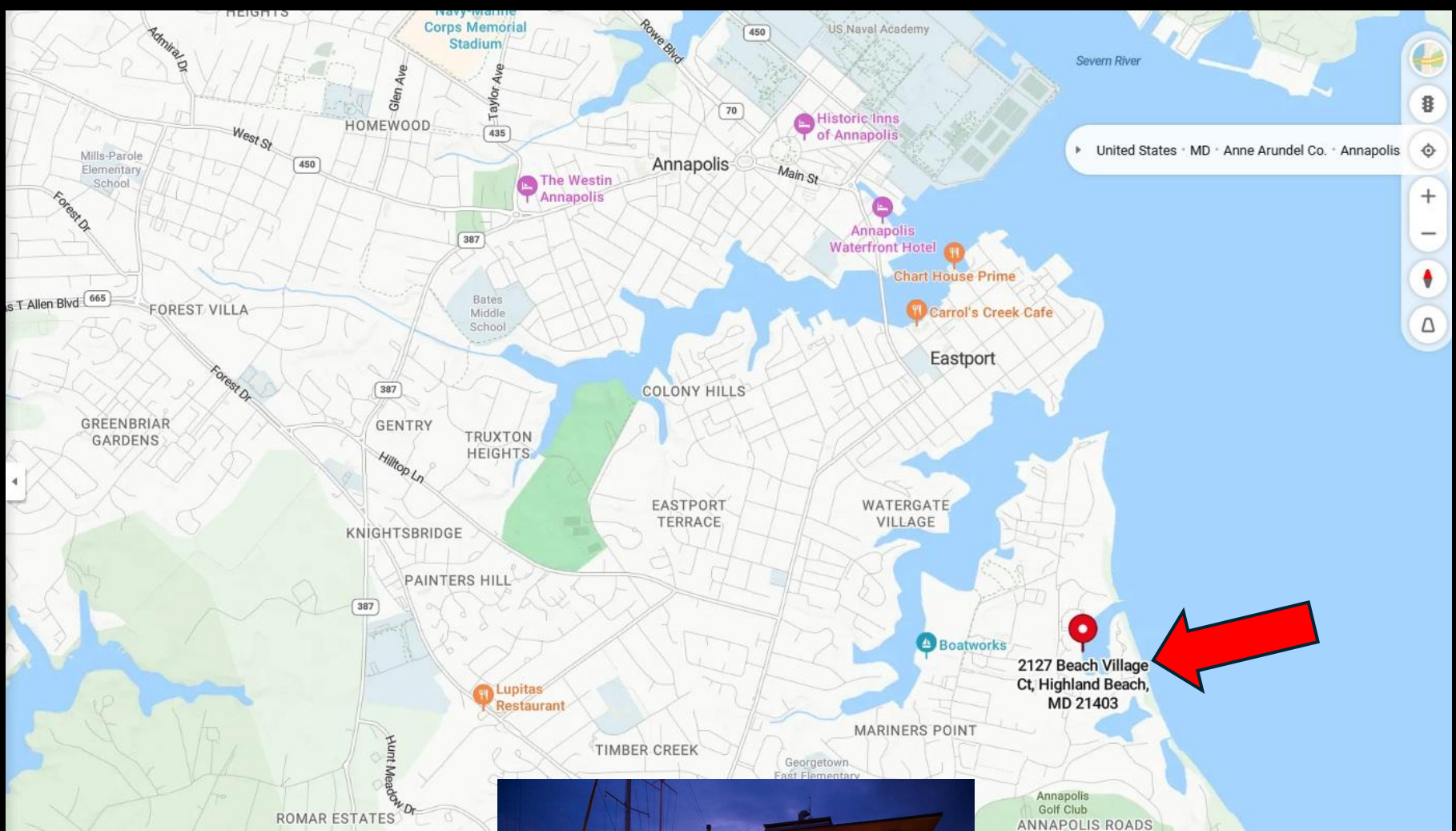

Location

Perched directly over the water with, arguably, one of the finest views in the community.

This exceptional waterfront residence offers a rare “surrounded by water” experience. From nearly every angle, your view is uninterrupted Chesapeake Bay — stretching to the Eastern Shore, the Bay Bridge, and the mouth of the Severn River, one of the region’s great crossroads for recreational boating.

10 minutes from historic Annapolis.





Annapolis

America's sailing capital-
10 min by car, or boat



Chesapeake Harbor deep-water, Marina is just a short walk away.



Amenities

Adjacent to the Marina is one of Annapolis's best located bar/restaurants, Beacon... with it's popular harbor front Tiki bar.





Your own resort

Everything is close at hand...

It's like having resort amenities in your own backyard, maintenance free!

Major shopping within a mile, marinas galore surround you. Major Airports as near as 35 min., private airport (Lee) within 10 min. Pub and fine dining on property, with lots more within 10 min.

About 2 mi. of shell path walking in Ches.Hbr.

Annapolis is 10 min away.





2127, arguably best location & view going.

Deck seats 8 comfortably, 12 or more for cocktails

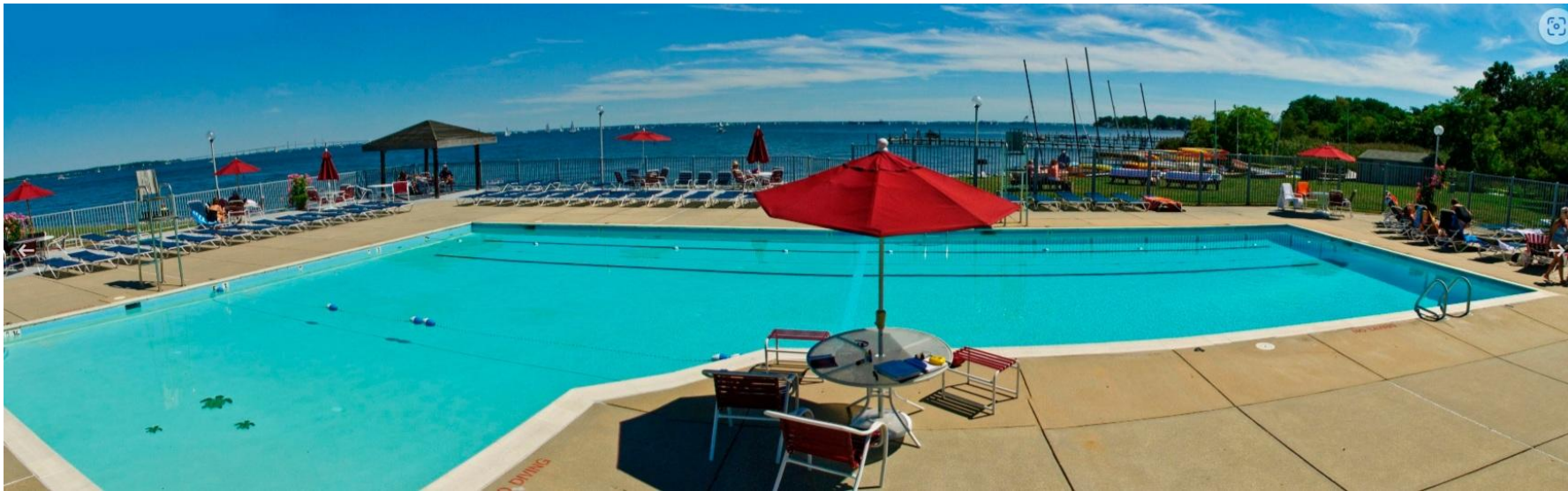

Watch events, like the Blue angels flyover, and Wed. nite races, right from your deck, or join the group on the community dock.



Resort style living & views

Second pool—heated.
Nature strolling shell paths throughout

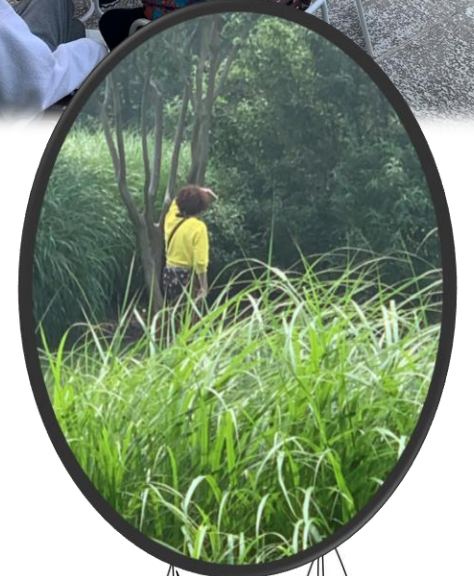



brighi M.S.



brighi M.S.

Welcome home

Where the indoors and outdoors merge...



Chesapeake Harbor is a welcoming gated waterfront community equally suited for full-time living, weekend escapes, second-home ownership, or investment opportunities.





Designer-selected tones throughout the home reflect the changing moods of the outdoors — soft greys and grey-blues echo the water and sky, while subtle sunrise-inspired oranges and purples bring warmth and character to the interiors.

Cherry wood floors and rich wood accents create a seamless connection between indoor living and the surrounding waterfront setting.

Home is Where the indoors and outdoors merge...

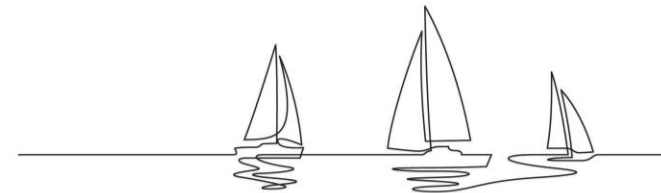



Family room

- Wide open to deck
- Wood burning fireplace
- Smart lights& Temp control
- Remote control blinds
- Smart sound, lighting-voice control

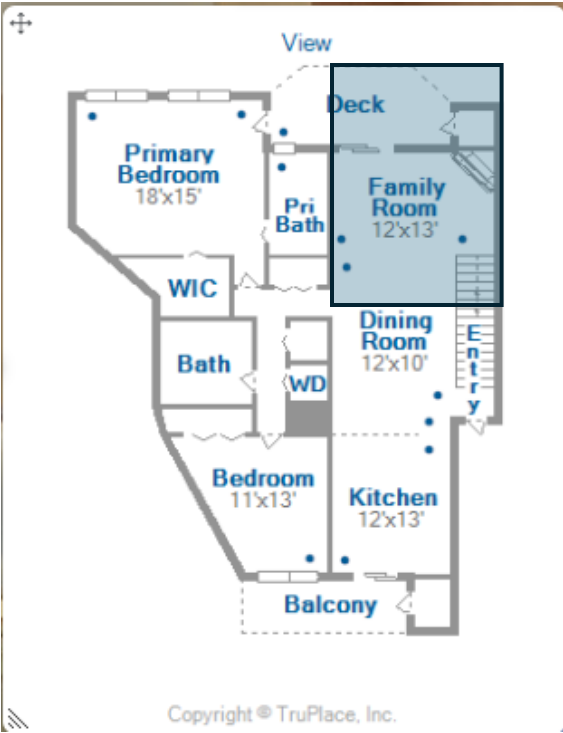



Interior...

Thoughtfully designed to maximize both efficiency and comfort, the residence is being offered completely furnished and turnkey, ready for immediate enjoyment. The home is equipped as a modern smart residence with voice-controlled lighting, speakers, and appliances, along with both wireless internet relay capability and hard-wired connectivity throughout.



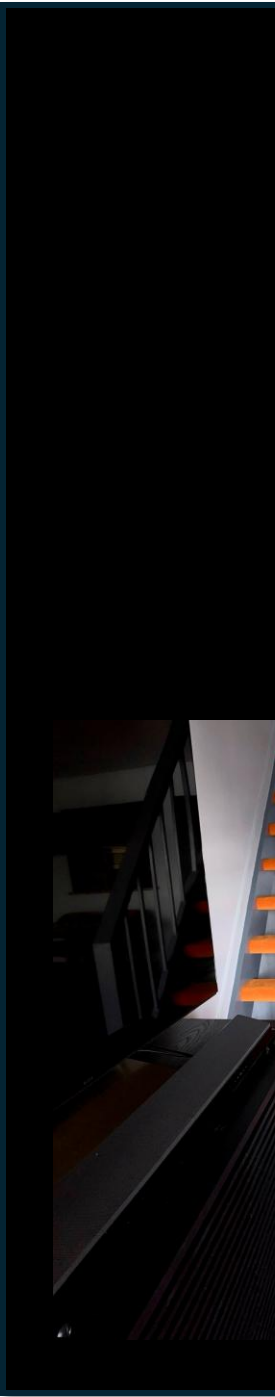

om
t, sunrise
set
d
bove,
light
ked sofas

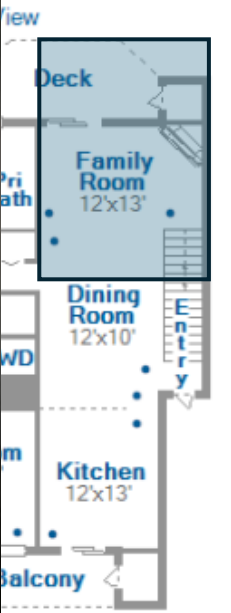



Dining area

4 place with 2 additional chairs for ends, kept at entryway. Dimmable smart, light fixture, kitchen pass trough-granite counter

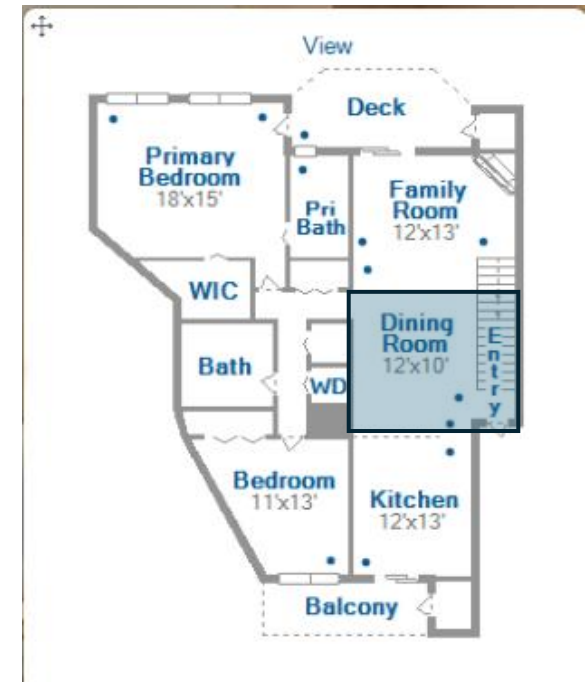

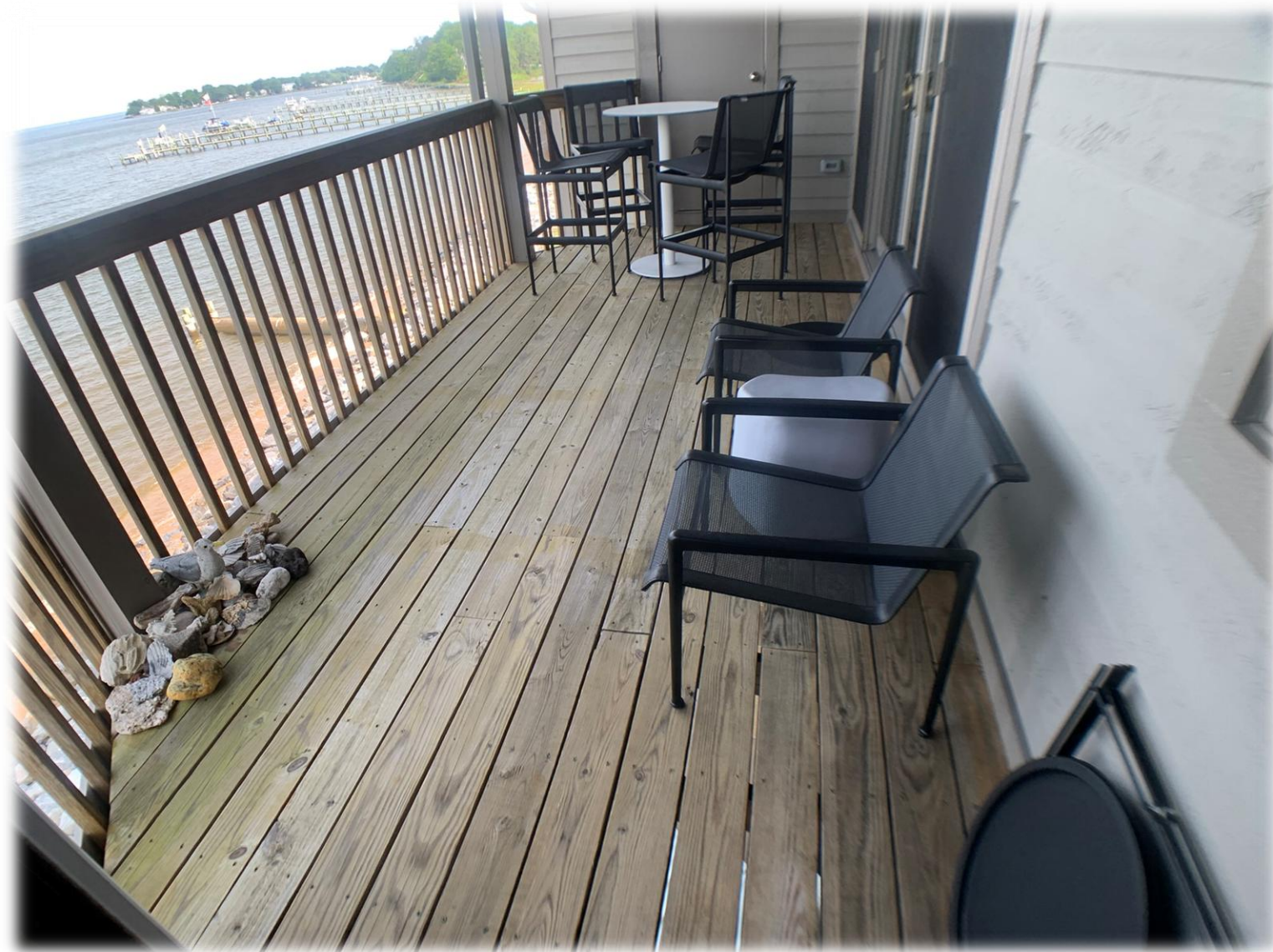

The Bay deck

Coffee or cocktails. Boat watching, or socializing

Shaded, sun-rise view.

Huge storage locker at end for Kayak equipment fire-wood and more.



Main deck, perched directly over the water with, arguably, one of the finest views in the community, this exceptional waterfront residence offers a rare “surrounded by water” experience. From nearly every angle, your view is uninterrupted Chesapeake Bay — stretching to the Eastern Shore, the Bay Bridge, and the mouth of the Severn River, one of the region’s great crossroads for recreational boating.





Galley

Smart stove--Induction cooking with Hot air oven, convection-microwave, dishwasher, Double sink garbage disposal, double door refrigerator (All New 24). Granite counters/back splash. Dining room pass through. Wheeled table—prep-eating island.

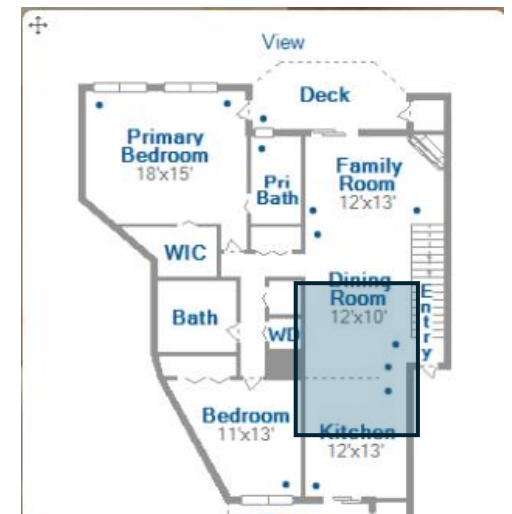

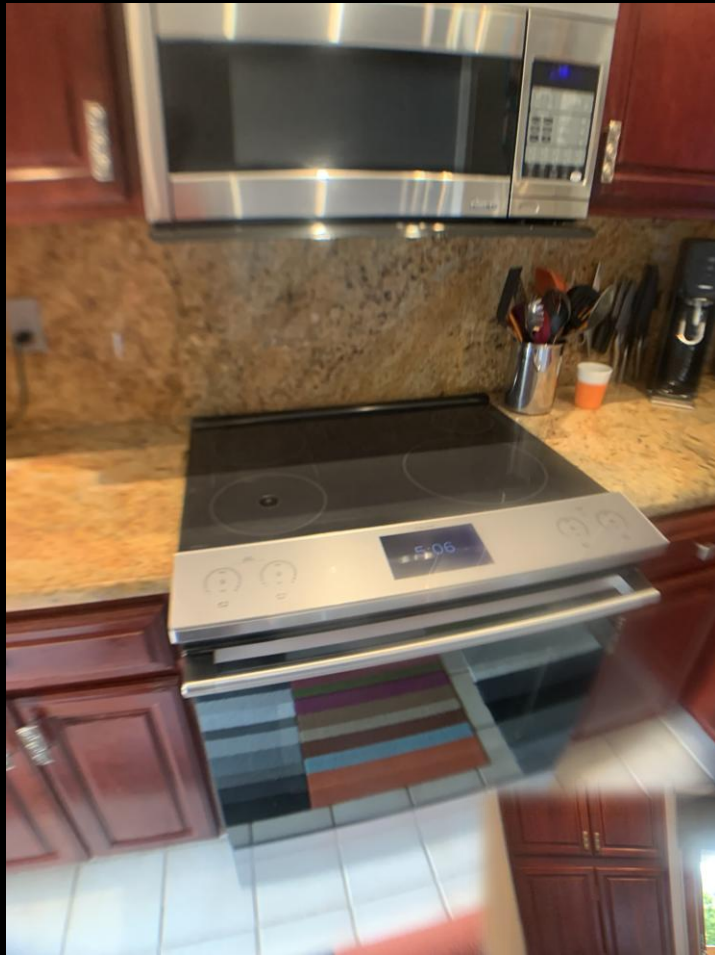

Kitchen, herb
planters



Chase Pond view from
front deck





Master BR

Master Bedroom

Smart lighting, electric blinds, fan, private balcony and master bath access.

Unobstructed, 3rd floor water view from king bed.

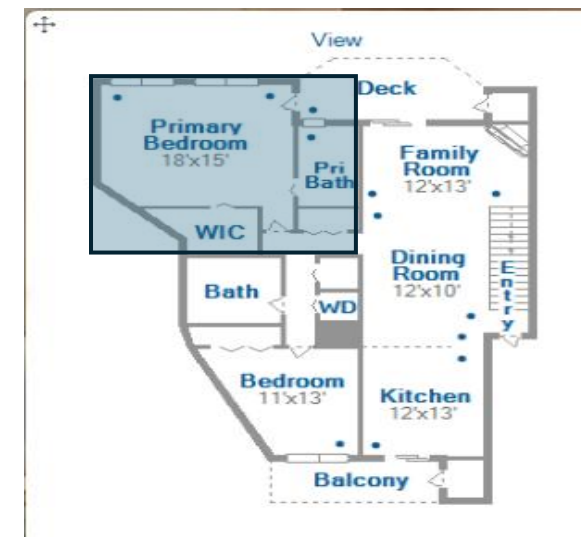

Master Features

- Electric blinds
- Smart lighting system
- Walk in closet (right)



- Walk out to main deck
- Windows at floor level—unobstructed Bay view





Master bath

- Compact, but practical
- Smart LED lighting
- Double sinks
- Huge double medicine cabinet and under sink storage.
- Tub/shower with window looking out onto the Bay.
- Walk in closet with pocket door—steps away
- **Toto elect/bidet toilet**

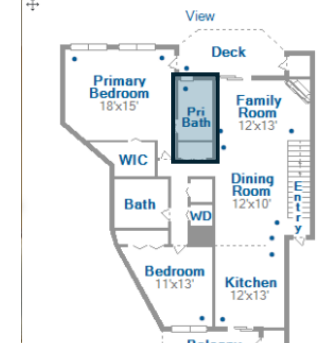

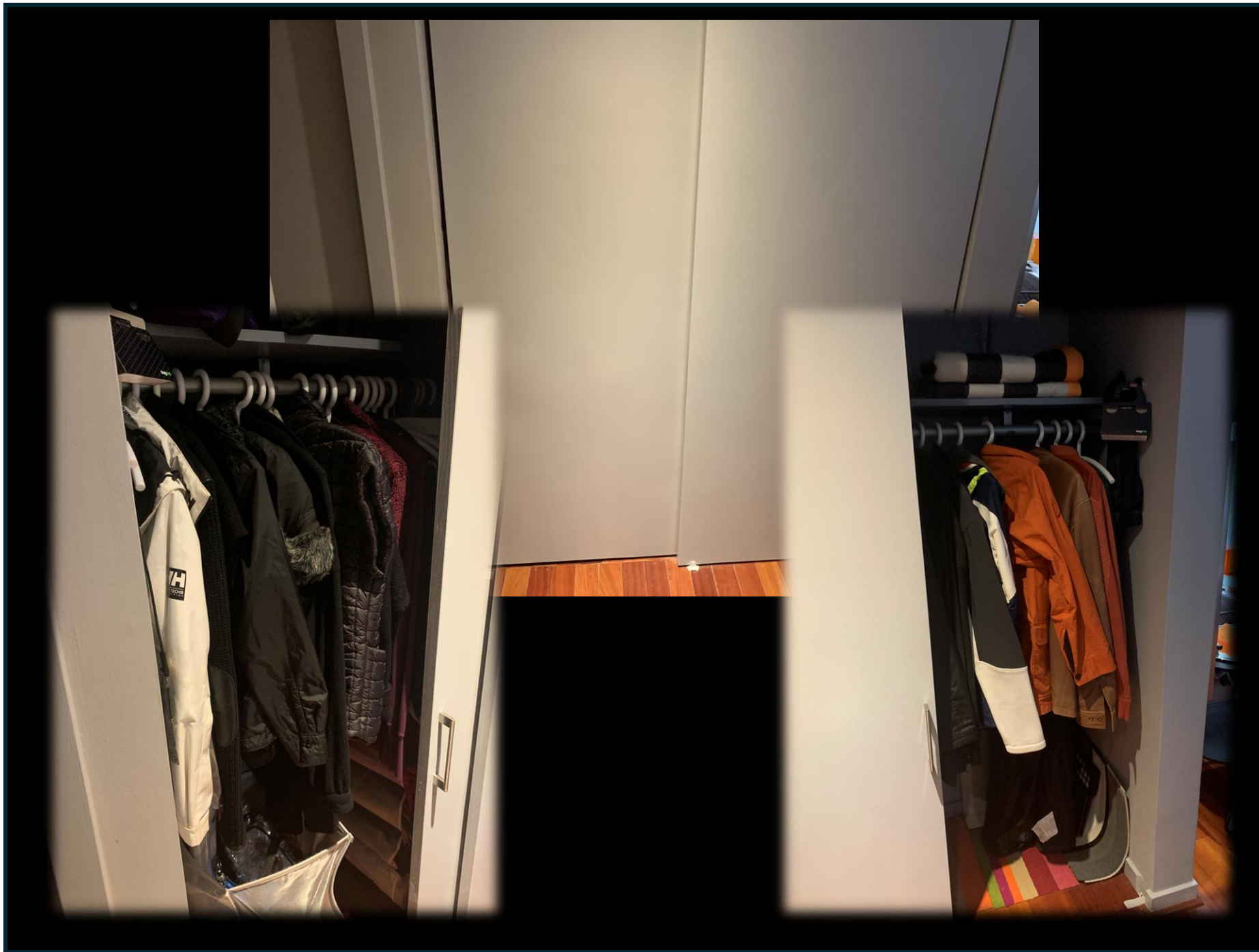

Transition space

Between family room and bedrooms.

Double coat/storage closet

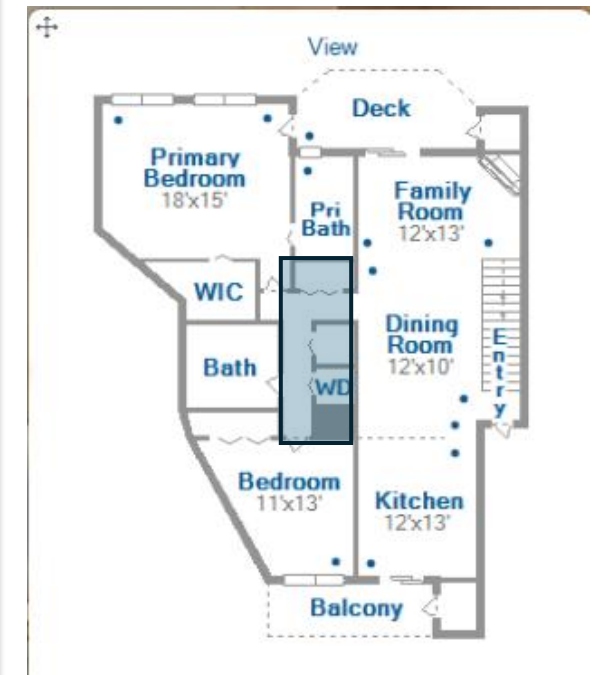

Utility rooms

- Full sized washer/ fully vented dryer
- Water heater/utility closet





Guest room

- Double closet
- Fan w/remote
- Direct access sliding door to entry side deck with view of Chase pond and sunset coffee/cocktail nook. On deck
- Queen size, lift storage bed

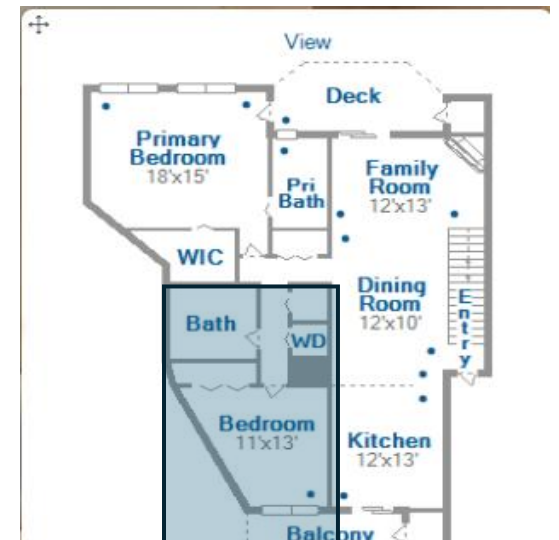

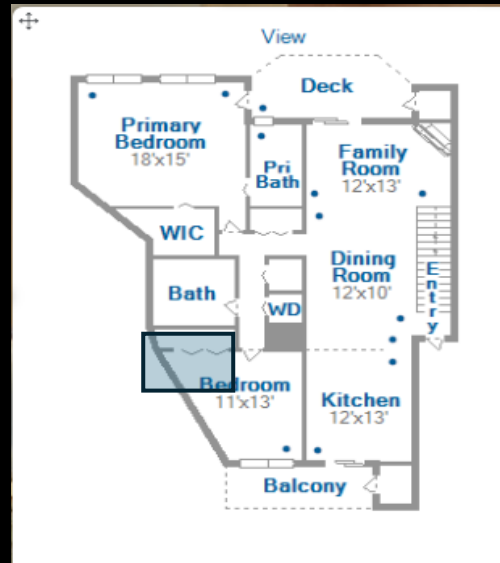

Guest bedroom

Light & bright with ample storage and direct access to chase pond balcony.



Guest Bath

Full bath for guest room or for general guests.

Bath tub with shower.
Smart LED lighting.

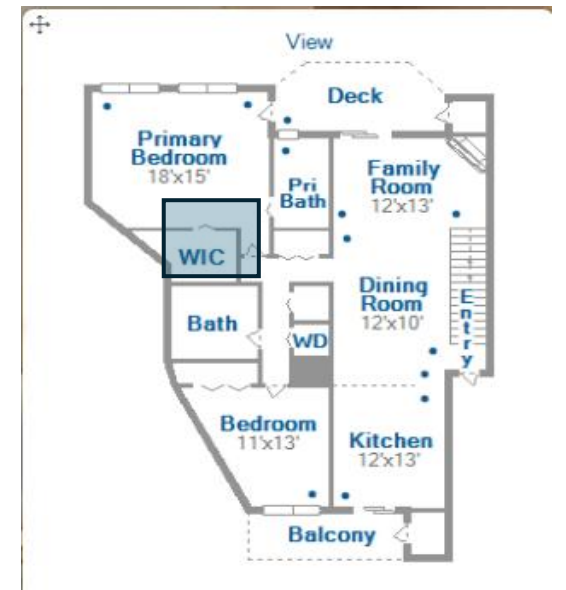

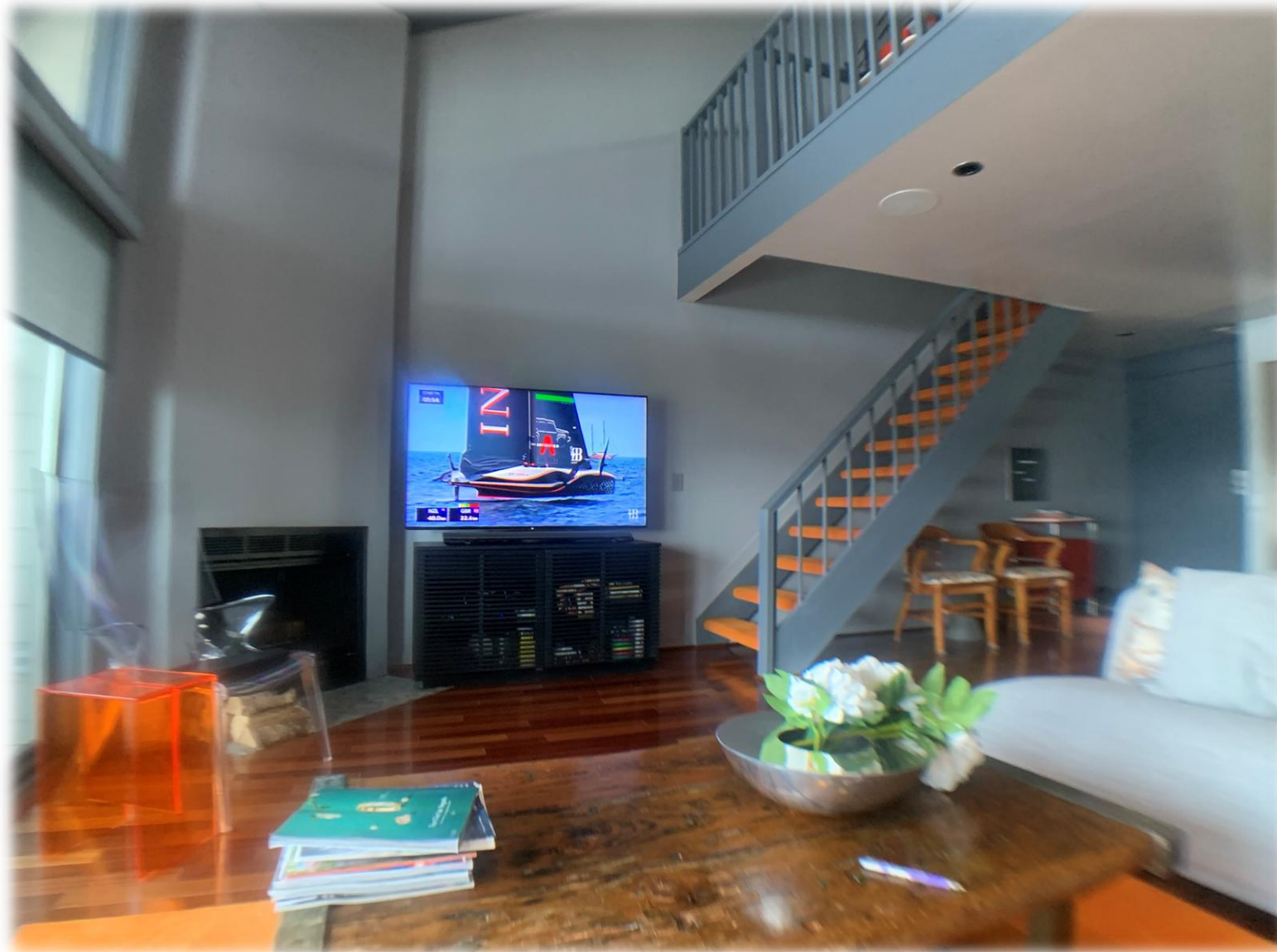

Upper loft

Upper loft, 3rd bedroom, office, exercise room—extra storage and a full bath. Several possibilities shown

Visually open stairway with bay view from entryway.

Note color palate of interior, chosen, to seamlessly transition to the Bay view.

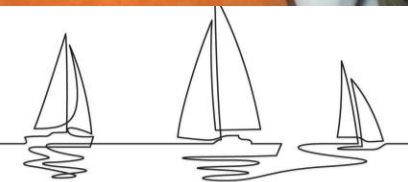

Loft-3rd bedroom



Set up with extra storage locker under eaves 8X10

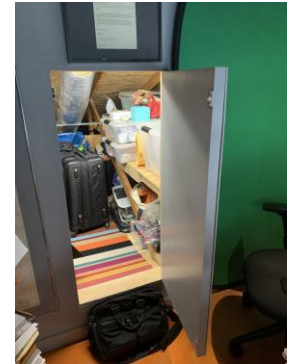
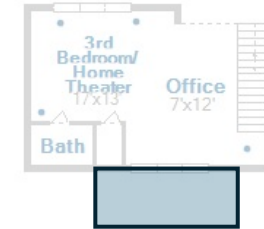

Additional 8' long overflow hanging space.

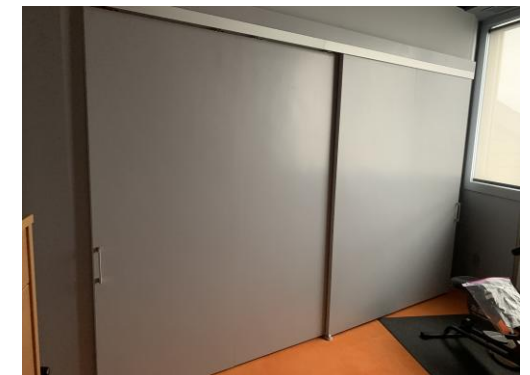

Pictures of loft are for informational purposes. Showing several pictures from other listings with similar loft space in the community—set up differently.

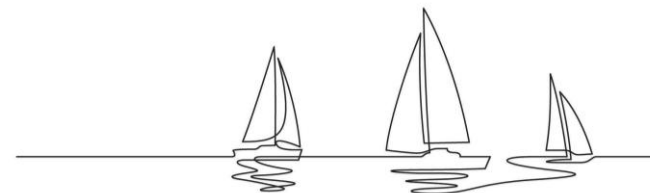

Loft full bath

Full bath in loft. Large shower.



Other ideas

From neighbors lofts.

- Combine functions
- Extra bedroom
- Exercise room
- Office



Skylight windows, clerestory windows, and opening windows to Bay views.



Mix & Match

Thoughtfully designed with exceptional built-in storage, this waterfront residence offers a compact yet highly practical layout with flexible living spaces and effortless, move-in-ready comfort for summer on the Chesapeake.

Full bedroom, or sofa bed, media room



Loft w/ Attic

Alternatives for illustration

Note, included:
2 fans, (88 bottle) wine rack at top of stairs, opening window look out to Bay over bedroom (Lower right), skylights above Office portion, smart lighting and sound system, Full bath and abundant storage





Office Studio

Currently set up as dual office, study, video creation studio, exercise room and overflow storage. Wine and cookbook rack, below



Resort style living

Your home. Quiet and serene, yet only steps from Chesapeake Harbor's resort-style amenities, including:

- waterfront pool
- pickleball and tennis courts
- natural beach
- kayak storage
- shell paths and waterfront walking trails
- electric vehicle charging stations
- Marina
- Restaurant/Tiki bar





Contact info

Eric Smith 410-703-5655
sailscapeese@gmail.com

Suzy Larson 443-994-3322
suzyonthesevern@aol.com

(Buyer agent participation welcomed)

HIGHLIGHTS...

- Sunrise view. Shaded/covered Bay View deck
- One unit in from corner unit. Total privacy.
- Pool and beach/kayak rack a few steps away.
- Tennis/ Pickle Ball Courts and electric vehicle charging-a few steps away.
- Community dock (Fishing, Wed. nite sailboat racing watch parties, socializing) adjacent to building
- Parking for owners and guests a few steps away

Offered fully furnished, see separate, detailed list of furniture.

[Link Furniture & Features.](#)

[Link to this listing](#)

Substantial upgrades accomplished: including all new appliances 2024; Complete home re-wiring including all new smart home features and all new recessed LED lighting.

Voice/smart phone controlled: lighting, climate, Alexa sound system, TV, & appliances.

This home is a rare, 3BR, 3 bath, loft unit waterfront, with the best views in the entire development.

Contact info

Your new sunrise view...





Chesapeake Bay/River View

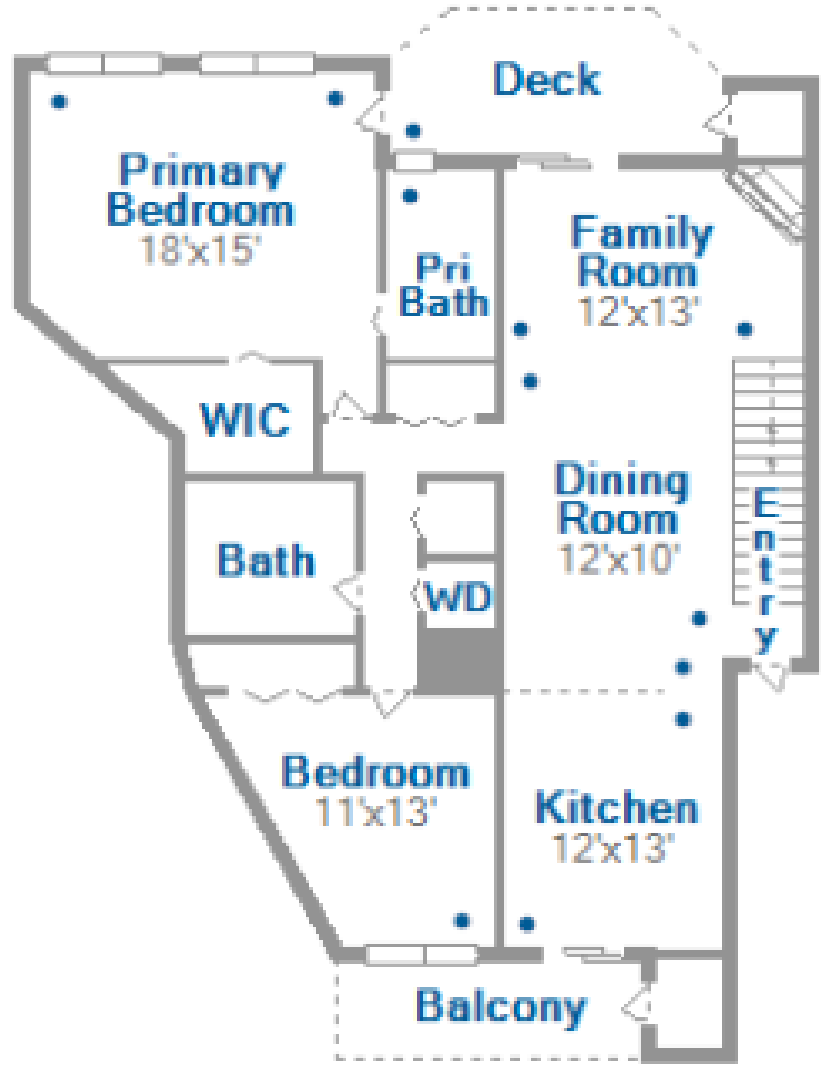

Chase Pond View

Highlights

- Resort style living with full walking distance amenities
- **Smart home**
 - Electric blinds
 - Phone/voice controlled: Lights throughout, sound system and thermostat.
 - Residents vote this unit best condo *view location* in Chesapeake Harbor.



Layouts

Measurements believed to be correct, but not guaranteed. Stated sq. 1800 sq.ft. Doesn't include outdoor and under eave storage closets.

Some info and specs, Gathered from sources believed to be reliable, but not guaranteed.

[Link to features & available furnishings](#), to Included as part of turn key package (AS SEEN IN LISTING AND DETAILED IN LINK)

